

1 x Bluetooth level sensor module  
1 x 10L waste container

Kit content includes:

720400

# Armed Bluetooth Waste Kit Instructions

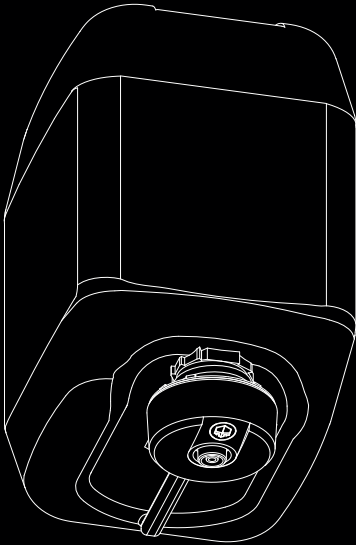

Scan QR code to watch How-to-video:

<https://www.borgandoverstrom.com/support/how-to-videos/>



Customer services:

[aftersales@borgandoverstrom.com](mailto:aftersales@borgandoverstrom.com)

call +44 1362 695 006

Telephone  
+44 (0)1362 695 006  
Email  
[sales@borgandoverstrom.com](mailto:sales@borgandoverstrom.com)

[borgandoverstrom.com](http://borgandoverstrom.com)

© Copyright Borg & Overström.  
This guide is printed by Borg & Overström and  
shall not be reproduced or copied in anyway.

Ref: 702170  
Version: 01

# Step-by-step Installation Instructions

This Bluetooth enabled waste kit provides a high-water level alarm which stops Bluetooth enabled units from further dispensing and beeps to indicate a full waste container.

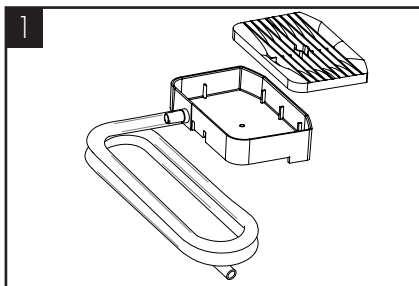

Select the correct drain kit for the unit you want to connect the waste kit to. Connect the new or existing drip tray to the waste pipe both provided in the kit and replace any fonts if required.

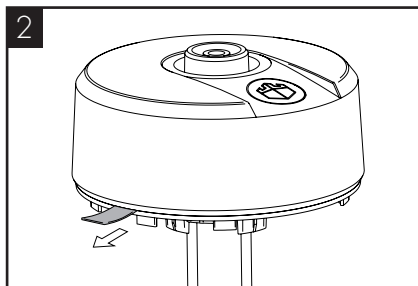

Remove the pull tabs under the batteries on the level sensor module. Once removed the level sensor will connect to all bluetooth units within a small area. If multiple level sensors are used only the closest unit to the level sensor will be triggered.

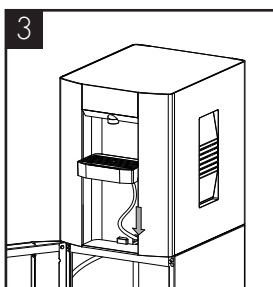

Remove the standard drip tray or drip tray plug from the unit. Replace with the new tray and feed the pipe through the unit and base cabinet or counter top.

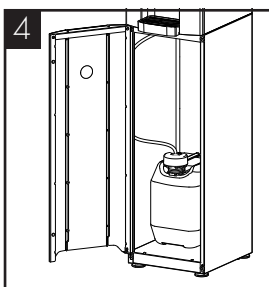

Ensure the drip tray is securely fitted. For base cabinets feed drain pipe down the side. Fit pipe to level sensor and waste container.

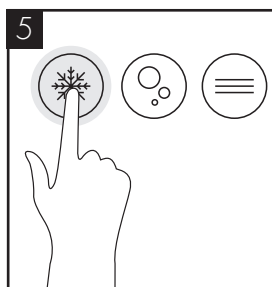

For any units you wish to not be triggered by the waste kit turn off the bluetooth on the unit by pressing the chilled icon 4 times and hold on the 5th press.

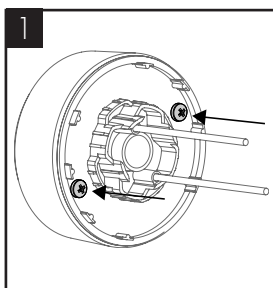

For battery removal and buzzer control, unscrew the two screws on the under side and remove the top cover.

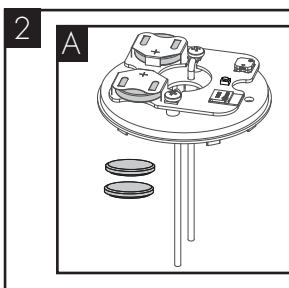

2A - Replace both batteries with correct orientation. Replace cover when complete.

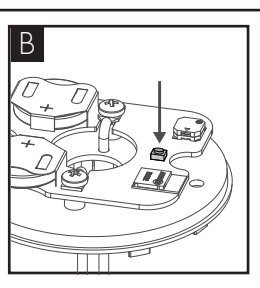

2B - Turn buzzer off or on by pressing button on the board. Replace cover when complete.